

# **DS8208/DS8288**

# **Digital Scanner**

# **Series**

## **Quick Start Guide**

MN-005223-02EN Rev. A

---



Zebra Technologies | 3 Overlook Point | Lincolnshire, IL 60069 USA  
[zebra.com](http://zebra.com)

2026/04/17

The Zebra wordmark and logo are trademarks of Zebra Technologies Corp., registered in many jurisdictions worldwide. All other trademarks are the property of their respective owners. ©2026 Zebra Technologies Corp. and/or its affiliates.

Information in this document is subject to change without notice. The software described in this document is furnished under a license agreement or nondisclosure agreement. The software may be used or copied only in accordance with the terms of those agreements.

For further information regarding legal and proprietary statements, please go to:

SOFTWARE: [zebra.com/informationpolicy](https://zebra.com/informationpolicy).

COPYRIGHTS: [zebra.com/copyright](https://zebra.com/copyright).

PATENTS: [ip.zebra.com](https://ip.zebra.com).

WARRANTY: [zebra.com/warranty](https://zebra.com/warranty).

END USER LICENSE AGREEMENT: [zebra.com/eula](https://zebra.com/eula).

## Terms of Use

### Proprietary Statement

This manual contains proprietary information of Zebra Technologies Corporation and its subsidiaries ("Zebra Technologies"). It is intended solely for the information and use of parties operating and maintaining the equipment described herein. Such proprietary information may not be used, reproduced, or disclosed to any other parties for any other purpose without the express, written permission of Zebra Technologies.

### Product Improvements

Continuous improvement of products is a policy of Zebra Technologies. All specifications and designs are subject to change without notice.

### Liability Disclaimer

Zebra Technologies takes steps to ensure that its published Engineering specifications and manuals are correct; however, errors do occur. Zebra Technologies reserves the right to correct any such errors and disclaims liability resulting therefrom.

### Limitation of Liability

In no event shall Zebra Technologies or anyone else involved in the creation, production, or delivery of the accompanying product (including hardware and software) be liable for any damages whatsoever (including, without limitation, consequential damages including loss of business profits, business interruption, or loss of business information) arising out of the use of, the results of use of, or inability to use such product, even if Zebra Technologies has been advised of the possibility of such damages. Some jurisdictions do not allow the exclusion or limitation of incidental or consequential damages, so the above limitation or exclusion may not apply to you.

## DS8208/DS8288 Quick Start Guide

### Model Numbers

This guide applies to the following model numbers:

- DS8208
- DS8208-HC
- DS8288
- DS8288-HC

### Unpacking the Scanner

Unpack the scanner from the box.

1. Carefully remove all protective material from the scanner and save the container for later storage and shipping.
2. Verify that the following are in the box:
  - Digital scanner
  - Quick Start Guide
  - Regulatory Guide
3. Inspect the equipment for any damage. If any equipment is missing or damaged, contact the Global Customer Support Center immediately.
4. Before using the device for the first time, remove the protective shipping film from the housing.

## Cordless DS8208 Scanner Features

Main features of the cordless scanner.

Figure 1 Cordless Scanner Features

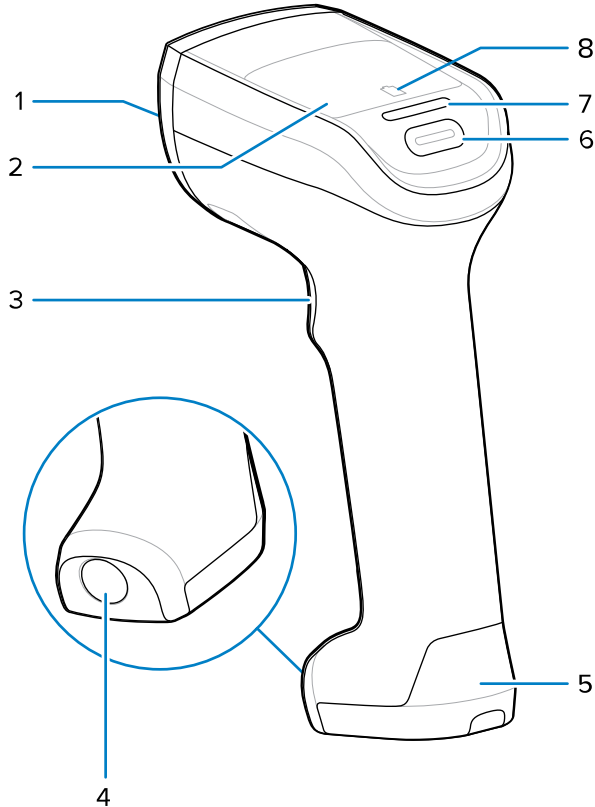

Number	Item	Description
1	Scan window	Point this window at a barcode to capture barcode data.
2	Speaker	Provides audio output indicating scanner status and activity.
3	Scan trigger	Initiates a barcode scan.
4	Screw cover	Creates a water-resistant seal protecting the battery cover screw.
5	Battery compartment cover	Holds a replaceable battery or PowerCap.
6	Programmable button	Programmable trigger. Default behavior: <ul style="list-style-type: none"> <li>• SR/DL: Secondary trigger.</li> <li>• HC: Toggles night mode.</li> </ul>
7	Scan LED	Indicates scan status.
8	Battery LED	Indicates battery level.

## Corded DS8208 Scanner Features

Main features of the corded scanner.

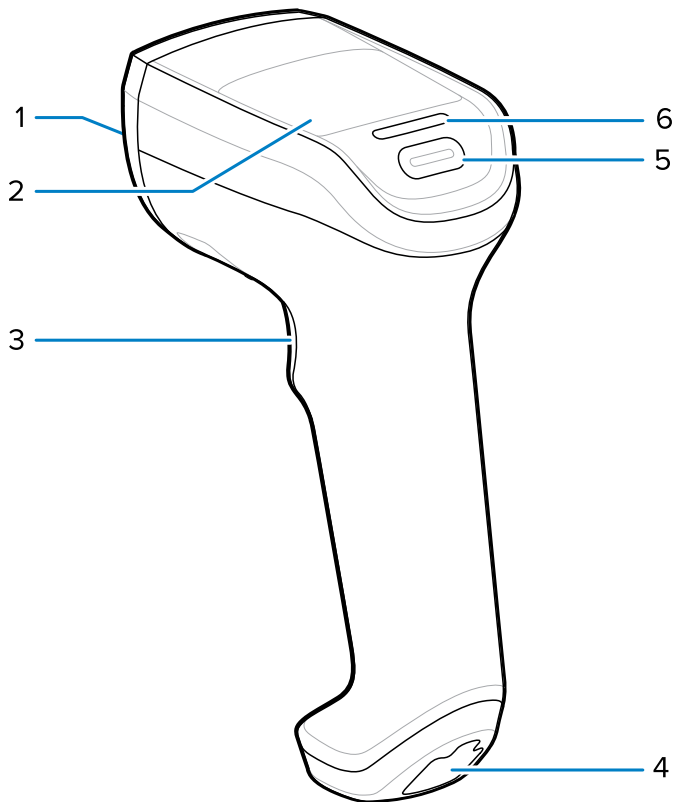

Number	Item	Description
1	Scan window	Point this window at a barcode when capturing data.
2	Speaker	Provides audio output indicating scanner status and activity.
3	Scan trigger	Operates the imager when scanning a barcode.
4	Port	Supports corded connection to host.
5	Programmable button	Programmable trigger. Default behaviors: <ul style="list-style-type: none"> <li>• SR/DL: Secondary trigger.</li> <li>• HC: toggles night mode.</li> </ul>
6	Scan LED	Indicates scan status.

## Replacing the Battery

Remove the battery compartment cover to access the rechargeable battery.



**NOTE:** Battery replacement instructions apply only to the cordless DS8288/DS8288R model.

1. Remove the battery screw cover.

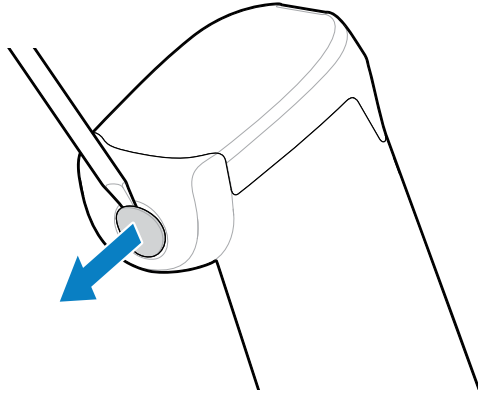

2. Use a T10 screwdriver to remove the screw.

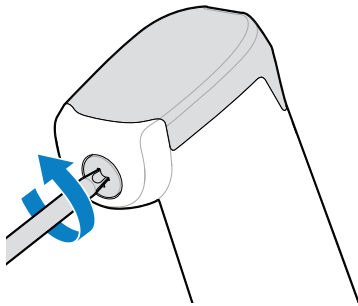

3. Slide the battery compartment cover off.

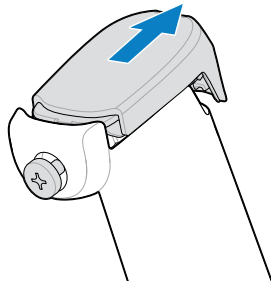

4. Remove the battery from the compartment.

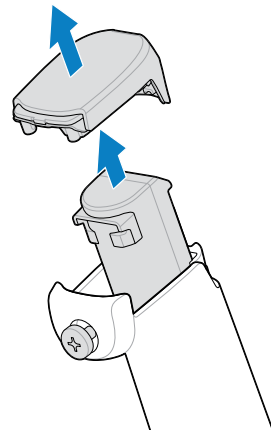

5. Replace the battery and compartment cover.

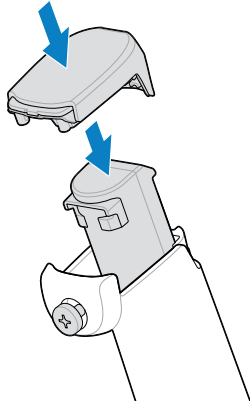

6. Slide the battery compartment cover into place.

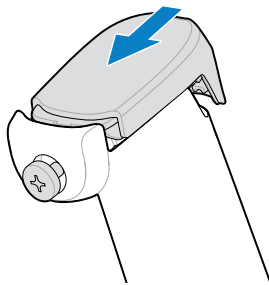

7. Secure the battery compartment cover with a T10 screwdriver to approximately 1.13 N-m (10 lbf-in.).

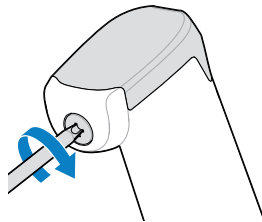

## Connecting the Cradle

Connect the cradle to a host device or power source to provide charging and/or communication with the host device. Both the USB-C and RJ50 cables provide communication and power.

You can plug in either the RJ-50 or USB-C cable to the cradle. Connect the cable to a power source to charge the scanner, or to a host device to provide both power and communication between the cradle and host device.



**NOTE:** You can use two cables simultaneously to increase charging speed; connect the RJ-50 cable to a host computer and the USB-C cable to a host or 5 VDC wall adapter.

- When both cables are connected, the RJ50 becomes the active path for all data.
- If the RJ50 does not have a valid host, the data path falls back to USB-C.
- Power is always consumed from the cable that provides faster charging.
- The cradle resets every time a change in cable configuration occurs.
- the USB BC 1.2 detection is supported on both RJ50 and USB-c connectors. Connect to BC 1.2-capable or USB-C host ports for fastest USB charging.

1. Connect the cable to the host computer or power supply.

If you are using the USB-C cable, use the USB-C to USB-A (CBL-U67-S07ZAR) or USB-C to USB-C (CBA-U65-S07ZAR) with a power adaptor or host computer.

2. Insert a cable into the cradle.

The cable should connect to the cradle before the host.

3. Route the cable through the cradle cable grooves, using the tabs to keep the cable in place.

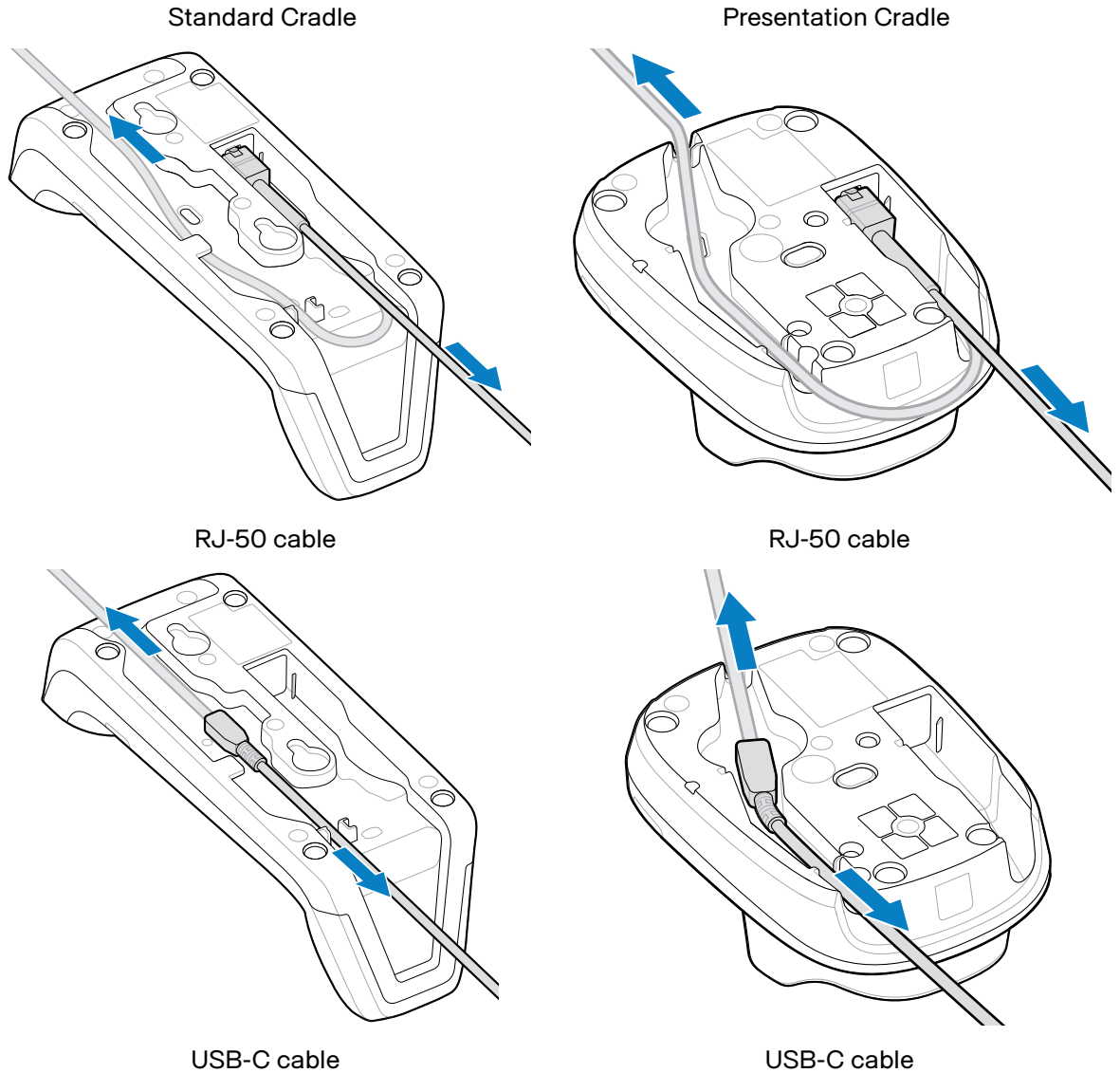

4. Pair the digital scanner to the cradle by inserting it in the cradle or by scanning the pairing code. The scanner is ready to charge or transmit barcode data to the host device.

## Inserting the DS8288 into the Standard Cradle

The CR8288 standard cradle charges the scanner battery. The insertion process is the same for horizontal and mounted cradles.

- For mounted cradles, ensure the latch points upward.
  - For horizontal cradles, ensure the latch points downward.
1. Slide the cradle magnet down towards the bottom of the cradle. (Healthcare models only).

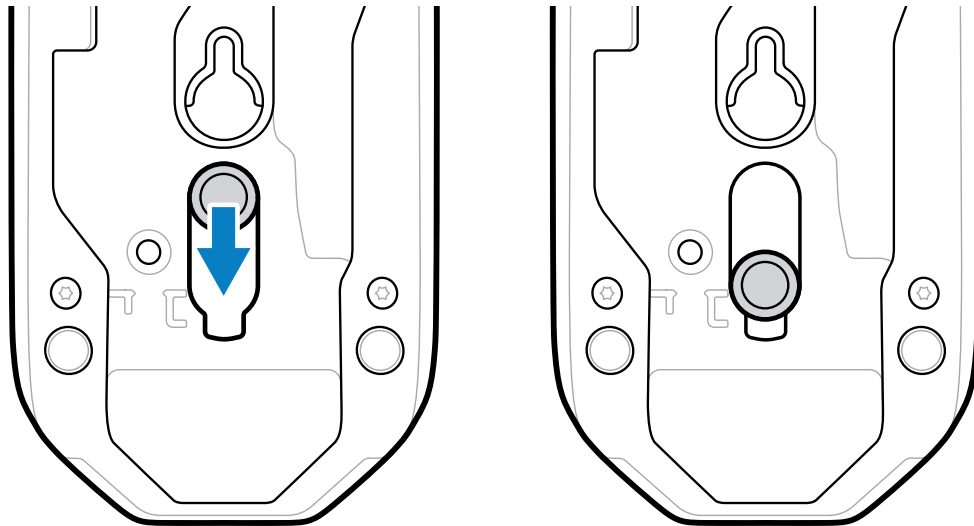

2. Insert the top of the scanner into the cradle.

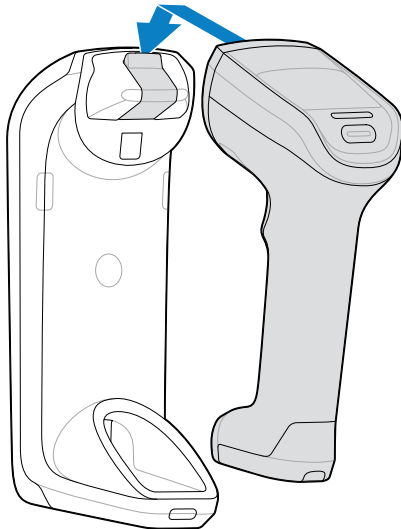

3. Press the handle towards the cradle until the bottom of the cradle is secure in the charging pad.

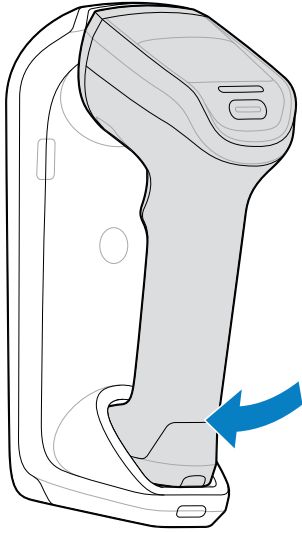

### Inserting the DS8288 Scanner into the Presentation Cradle

The presentation cradle charges the scanner battery and supports hands-free scanning in Presentation Mode. The insertion process is the same for horizontal and mounted cradles.

1. Insert the scanner straight down into the cradle.

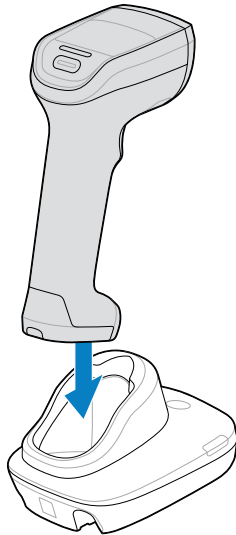

2. Rotate the scanner forward to engage the bottom of the scanner with the charging pad.

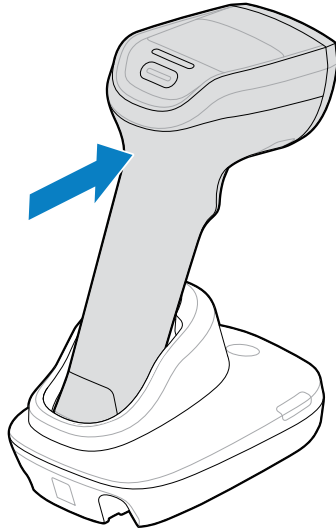

## USB Host Interface

A USB connection to a host device provides power and communication to the scanner (via a cable for corded DS8208/DS8208R or via the cradle for cordless DS8288/ DS8288R models). If necessary, scan the appropriate barcode to finish connecting the devices.

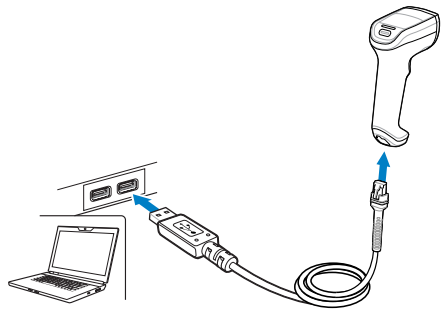

Corded DS8208/DS8208R USB Connection

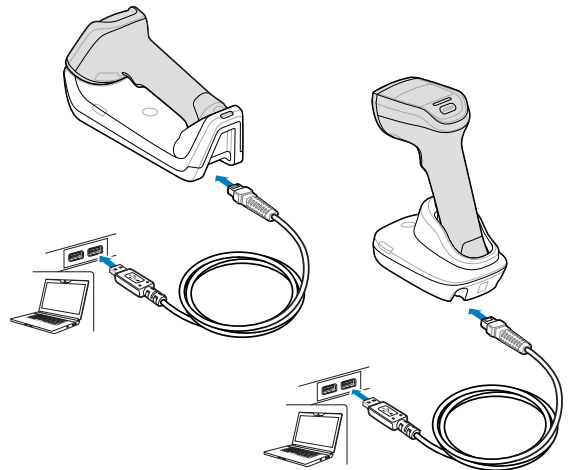

Cordless DS8288/DS8288R USB Connection

If the scanner does not connect to your device with the cable connection, scan the appropriate barcode.



\*USB HID Keyboard



Symbol Native API (SNAPI) with Imaging Interface

### RS-232 Host Connection

An RS-232 connection to a host device provides power and communication to the scanner (via a cable for corded DS8208/R or via the cradle for cordless DS8288/R models). If necessary, scan the appropriate barcode to finish connecting the devices.

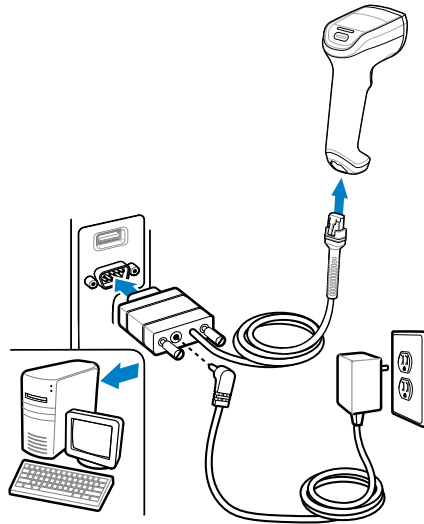

Corded DS8208/R RS-232 Connection

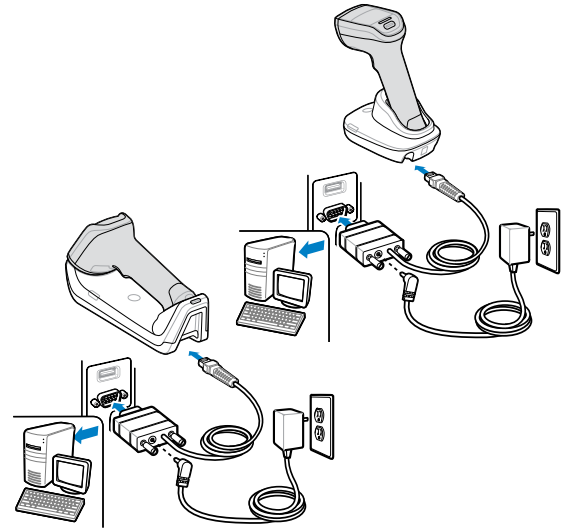

Cordless DS8288/R RS-232 Connection

If the scanner does not connect to your device with the cable connection, scan the appropriate barcode.



\*Standard RS-232



ICL RS-232

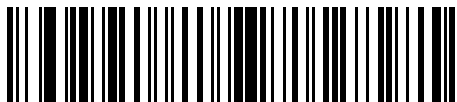

Nixdorf RS-232 Mode A



Nixdorf RS-232 Mode B



OPOS/JPOS



Fujitsu RS-232

## Aiming

Aim the scanner exit window at the center of the barcode. When scanning, the scan window projects a green LED dot, allowing you to align the barcode and scanner's field of view.

If necessary, the scanner turns on its illumination LEDs to illuminate the barcode. The scanner decodes barcodes only when the dot is on the barcode.

**Figure 2** Scanner Aiming

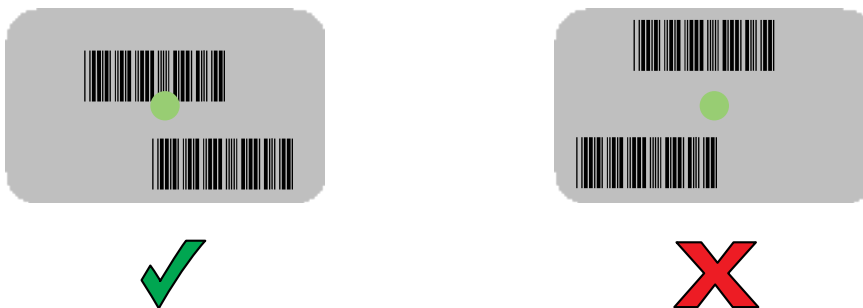

The aiming dot is smaller when the scanner is closer to the barcode and larger when it is farther away. Scan barcodes with smaller bars or elements (mil size) closer to the scanner and those with larger bars or elements (mil size) farther from the scanner.

The scanner beeps to indicate that it successfully decoded the barcode. For more information on beeper and LED definitions, see the [Scanner Indications Table](#).

## Hand-Held Scanning

Press the trigger to scan in hand-held mode.

1. Connect the scanner with a host device.
  - Coded DS82208 scanner: Ensure the cable is securely connected to the scanner and host device.
  - Cordless DS8288/ scanner: Ensure the scanner is paired to a cradle.
2. Point the scanner at a barcode.

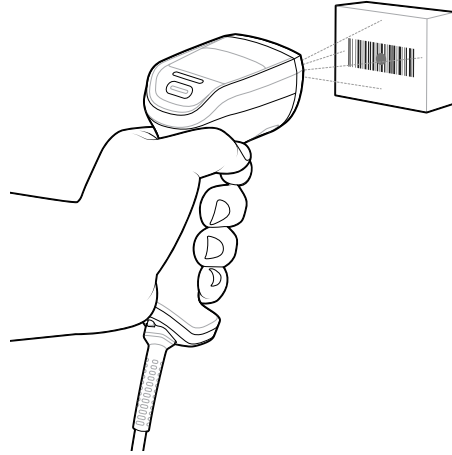

DS8208

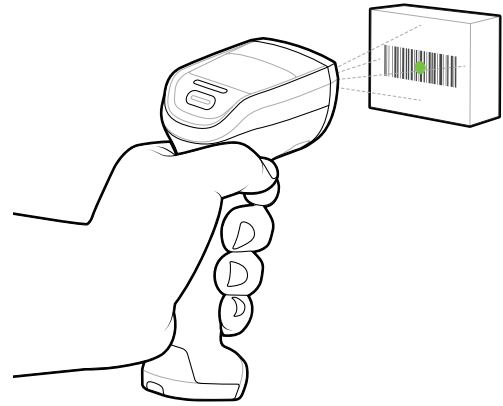

DS8288

3. Press and hold the trigger.
4. Ensure the barcode is within the area formed by the aiming pattern.

The aiming dot increases visibility in bright lighting conditions.

Upon a successful decode, the scanner beeps and the scan LED flashes green.

## Hands-Free Scanning

During idle conditions, the scanner operates in object detection mode and automatically wakes up to decode a barcode presented in the field of view. In object detection mode, it is normal for the illumination LEDs inside the scan window to be dimly lit.

1. Ensure the scanner is connected to a host device.
  - Corded DS8208 scanner: Ensure the cable is securely connected to the scanner and host device
  - Cordless DS8288 scanner: Ensure the scanner is paired to the presentation CR8288-PC cradle.
2. Present the barcode in the scanner's field of view.

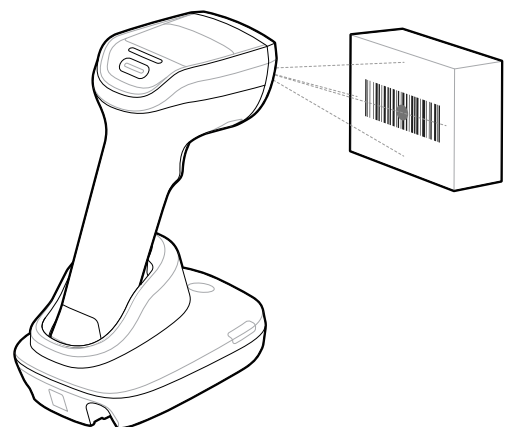
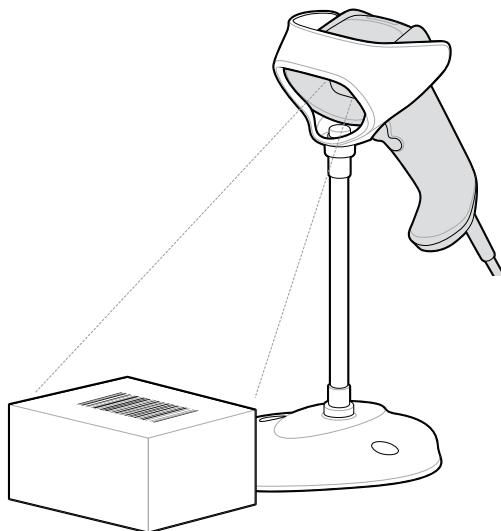

DS8208

DS8288

Upon a successful decode, the scanner beeps and the LED flashes green.

### Useful Barcodes

This section gives you quick access to commonly used barcodes. For a full list of scanner barcodes, refer to the DS8208/DS8288 Product Reference Guide.



Set Defaults

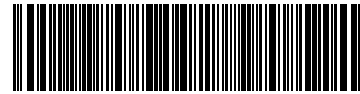

Add a Tab Key

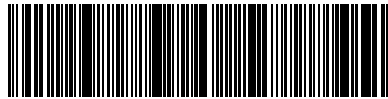

Add an Enter Key

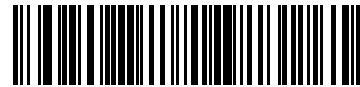

Override Caps Lock Key (Enable)



\*Do Not Override Caps Lock Key (Disable)



Enable Night Mode



Disable Night Mode



Toggle Night Mode

## Beeper Indications

The scanner emits different beeps to communicate its status. The following table lists the meaning of each beeper sequence.

Indication	Beeper Sequence
Power up	Low/medium/high beeps
Barcode decoded	Medium beep
Transmission error detected; data is ignored	Four long low beeps
Successful parameter setting	High/low/high/low beeps
Correct programming sequence performed	High/low beeps
Incorrect programming sequence or <b>Cancel</b> barcode is scanned	Long low/long high beeps
Low battery cap indication when trigger releases (cordless DS8288 model only)	Four short high beeps

## LED Indications

The scanner's LEDs illuminate to indicate scanner status. The following table describes the meanings of the LED indications.

Indication	LED Indicator
<b>Hand-Held Scanning</b>	
The scanner is on and ready to scan, or no power to the scanner	Off
Barcode is successfully decoded	Green flash
Transmission error	Red
Paging state	Blue (fast fast slow)
<b>Hands-Free (Presentation) Scanning</b>	
No power to scanner	Off
Digital scanner is ready to scan	Green
Barcode is successfully decoded	Off momentarily
Transmission error	Red

## Troubleshooting

Use this table to troubleshoot the scanner.

Problem	Possible Causes	Possible Solutions
The scanner is not working.	No power to the scanner.	Check system power. For cordless models, ensure the battery/PowerCap is charged.
	Scanner is disabled.	Ensure that the correct host interface cable is used.

Problem	Possible Causes	Possible Solutions
The scanner decodes barcodes but does not transmit data to the host.	Improper host interface configuration.	Scan appropriate host parameter barcodes.
	Loose interface cable.	Ensure all cable connections are secure.
	Invalid ADF rule.	Program the correct ADF rules.
	Scanner not paired to cradle.	Scan cradle pairing barcode.
The scanner is not decoding barcodes.	Scanner not programmed for barcode type.	Ensure the scanner is programmed to read the type of barcode being scanned.
	Unreadable barcode.	Ensure the barcode is not defaced; try scanning a test barcode of the same barcode type.
	Incorrect distance between scanner and barcode.	Move the scanner closer to or further from the barcode.
Scanned data displays incorrectly on the host.	Improper host interface configuration.	Scan appropriate host parameter barcodes.
	Region configured improperly.	Select the appropriate country and language encoding scheme.

## Ergonomic Considerations

Follow these ergonomic recommendations for an optimum scanning experience. Zebra recommends taking breaks and rotating tasks to prevent strain.

### Optimum Body Posture

Avoid bending

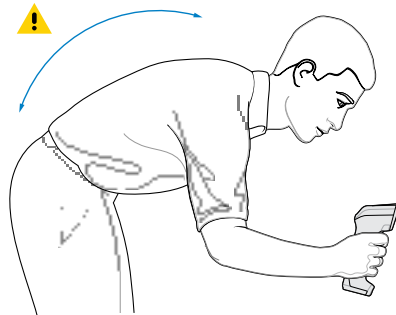

Avoid reaching

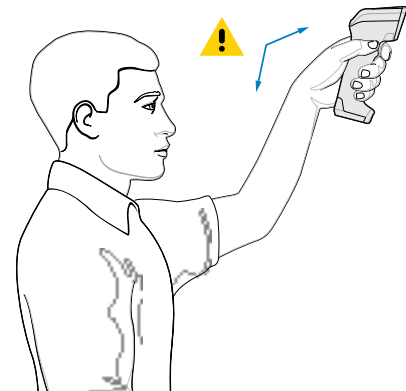

**Avoid Extreme Wrist Angles**

